

Flat 47, The Point, Marina Close,
Boscombe, Bournemouth, Dorset, BH5

Guide Price **£495,000**



2

Bedrooms



1

Living



2

Bathroom/Ensuite



Y

Allocated Parking

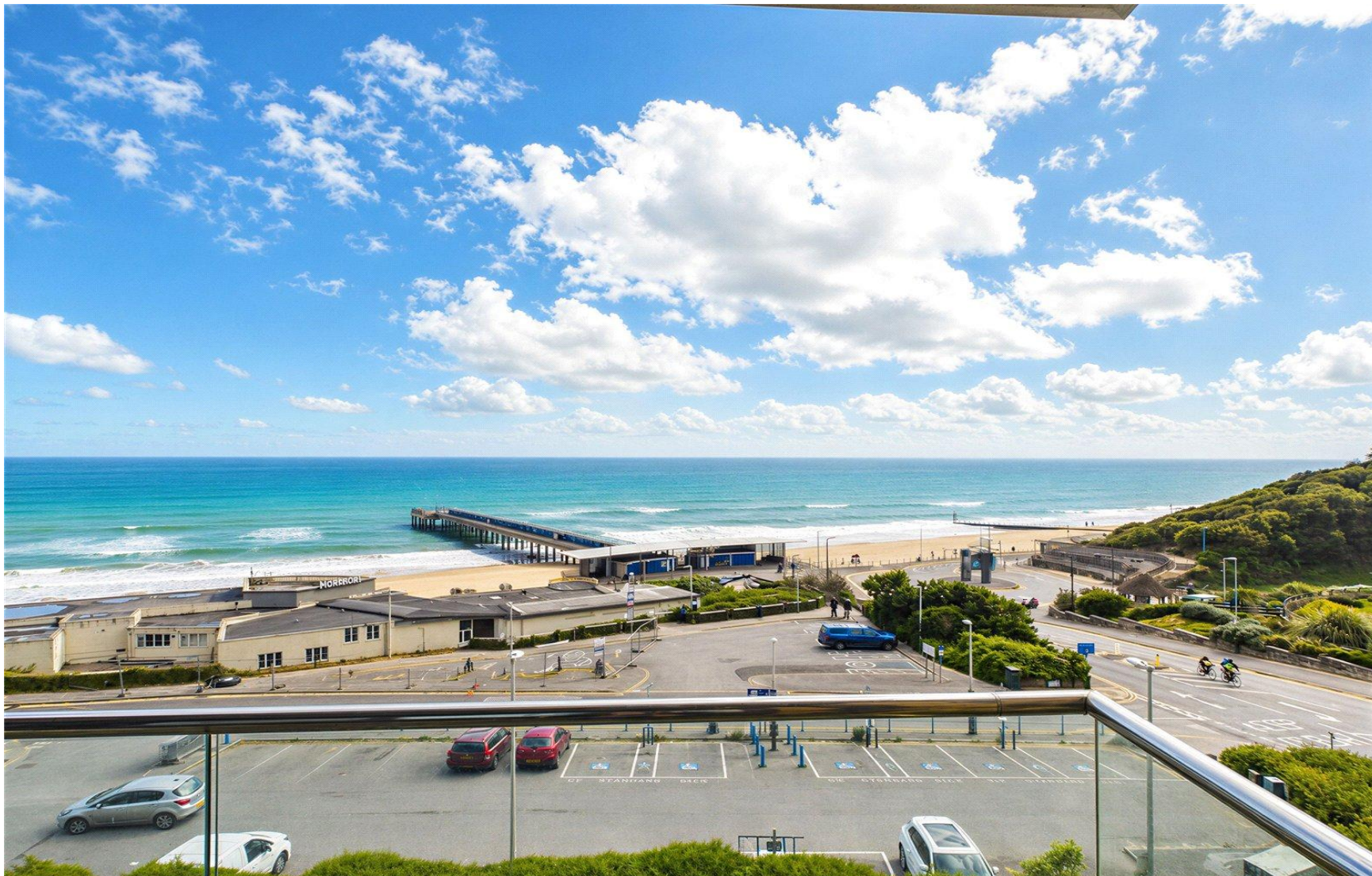

EST
1992

THE PROPERTY PROFESSIONALS
Slades Estate Agents

Slades

Frontline Apartment Offering Breath-Taking Sea Views!

A BEAUTIFULLY PRESENTED TWO-BEDROOM, TWO-BATHROOM APARTMENT DIRECTLY OVERLOOKING THE BEACH AT BOSCOMBE SPA! BOASTING A SOUTH FACING BALCONY AND BREATHTAKING SEA VIEWS, THIS TRULY IS A MUST-SEE PROPERTY!

The Point is a landmark development situated just moments from Boscombe Pier and the area's associated seven miles of sandy blue flag beaches. Resident's benefits include a concierge service and secure gated/ underground parking for both residents and visitors.

The apartment is positioned on the south side of the fourth floor with lift access. Recently re-decorated by the current owners, the apartment boasts new carpets throughout and a refurbished kitchen/breakfast room with Bosch appliances, quartz worktops and Karndean flooring.

The kitchen/breakfast room enjoys floor-to-ceiling windows and is accessed via double doors off the generously proportioned lounge/diner. Both rooms offer spectacular sea views.

Bedrooms one and two are both doubles, with the master benefitting from a well appointed en-suite bathroom including a walk-in shower. In addition, there is a separate shower room / cloakroom.

Externally the apartment benefits from a sizeable private balcony (approx. 20' in length) where uninterrupted views towards Sandbanks and Old Harry Rocks can be enjoyed.

A fantastic opportunity to acquire a beautifully presented frontline apartment, contact Slades Estate Agents to arrange your in-person viewing Today!

THE TENURE: We are informed that there are approximately 101 years remaining on the lease. Maintenance is charged at approximately £3,992 per annum and Ground Rent at £600 per annum.



KEY POINTS

- Spectacular, Uninterrupted Sea Views!
- Allocated Parking
- 20' Wide Private Balcony
- Two Double Bedrooms
- En-Suite to Master

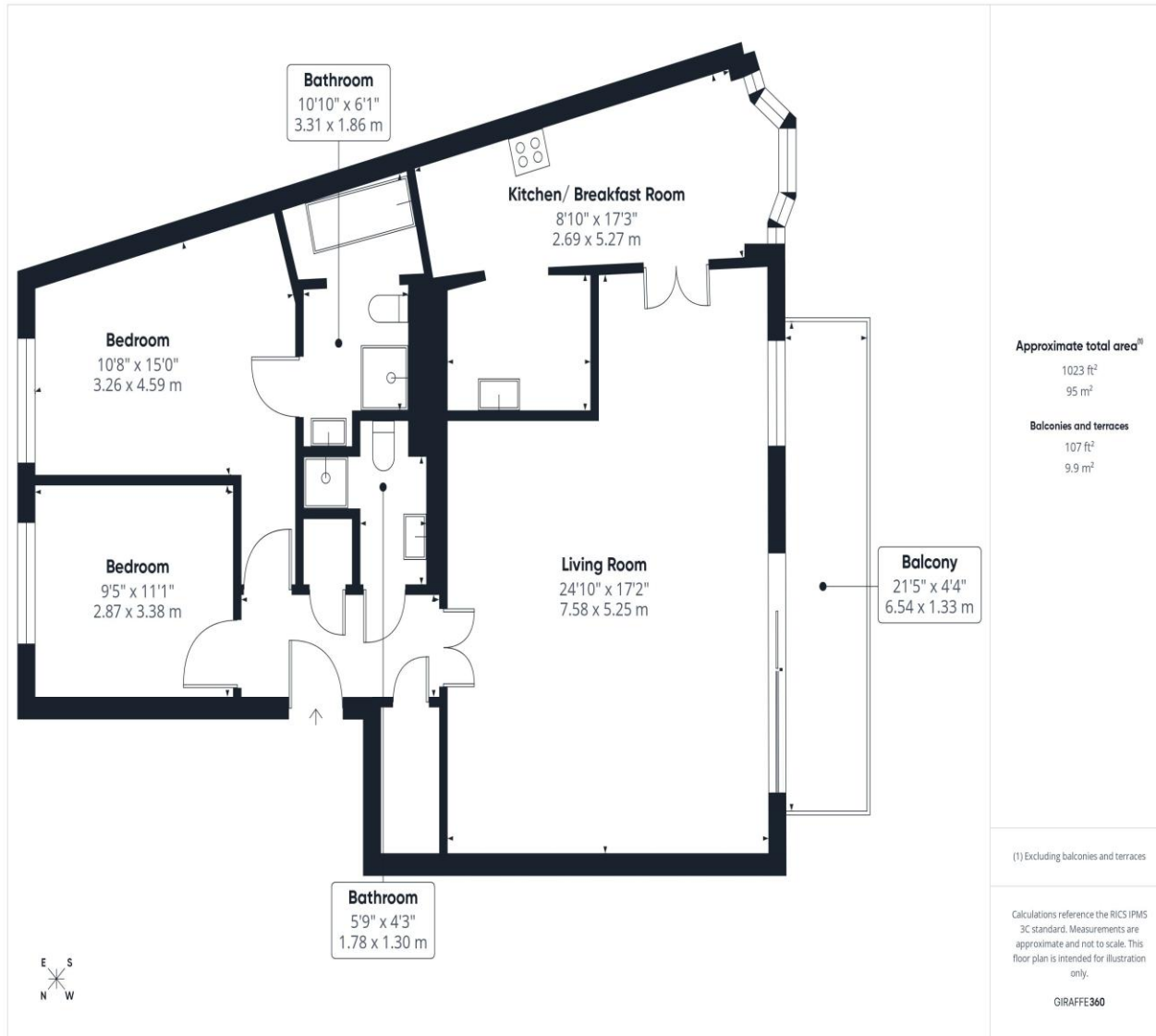

The Consumer Protection from Unfair Trading Regulations 2008 (CPRs). These details are for guidance only and complete accuracy cannot be guaranteed. If there is any point, which is of particular importance, verification should be obtained. They do not constitute a contract or part of a contract. All measurements are approximate. No guarantee can be given with regard to planning permissions or fitness for purpose. No apparatus, equipment, fixture or fitting has been tested. Items shown in photographs are NOT necessarily included. Interested Parties are advised to check availability and make an appointment to view before travelling to see a property.

THE PROPERTY PROFESSIONALS Christchurch | Southbourne | Highcliffe | Bransgore

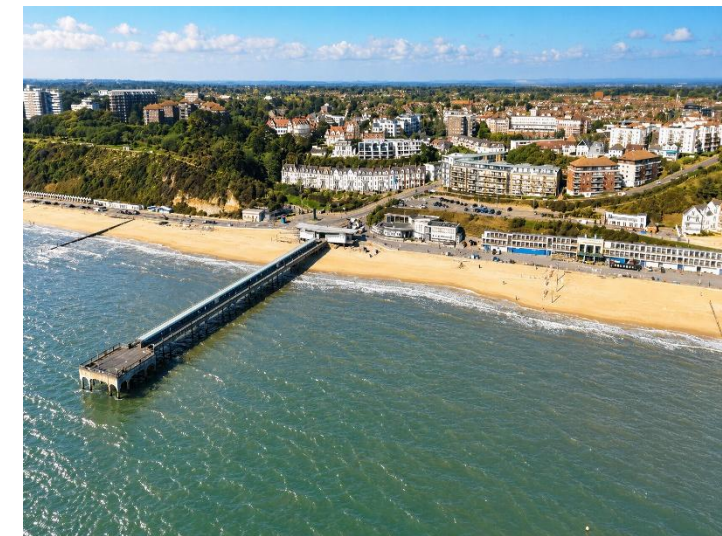

Slades - Southbourne 51 Southbourne Grove, Bournemouth, Dorset, BH6 3QT
01202 428555 | sales@sladessouthbourne.co.uk
Website www.sladeshomes.co.uk

