

Echo Beach, 69-71 Boscombe Overcliff
Drive, Southbourne, Bournemouth, Dorset,

Prices from
£595k to £1.55m

 2/3

Bedrooms

 1

Living

 2

Bathroom/Ensuite

 1/2

Underground parking



EST
1992

THE PROPERTY PROFESSIONALS
Slades Estate Agents

Slades

Your chance to start living the coastal dream... **echo**beach

Over 50% Already Reserved/Sold! CURRENTLY UNDER CONSTRUCTION, ECHO BEACH IS A LUXURY CLIFF TOP DEVELOPMENT OF 12 SPACIOUS APARTMENTS AND 2 WONDERFUL PENTHOUSES. ALL HOMES ARE SOUTH FACING WITH PRIVATE BALCONIES OR PATIOS GIVING WONDERFUL SEA AND COASTAL VIEWS. OFF PLAN RESERVATION NOW AVAILABLE!

Occupying a prime 'frontline' position on this increasingly popular and sought-after stretch of coastline, homes at Echo Beach will offer wonderful views across the Boscombe Overcliff and Poole Bay beyond, with upper floors set to give a sensational panorama stretching from The Isle Of Wight in the East right the way across to Sandbanks and The Isle Of Purbeck in the West.

The areas golden sandy beaches are easily accessible via the nearby Fisherman's walk zig-zag or cliff lift, and Southbourne's popular high street is also just a short (0.5 mile) walk away offering a wealth of shopping facilities, coffee shops and places to dine.

The development is the latest to be commissioned by Jackson Developments who are a local family run company established in 1991. With a proven track record in the development of high-quality homes, and with Directors who proudly pay particular attention to detail, homes at Echo Beach are set to be very special indeed.

Construction of Echo Beach is now underway with completion likely by November 2025. With new-build opportunities along this sought after stretch of coast always highly prized, we are now delighted to exclusively offer the opportunity of early reservation and exchange, which may also bring some choice of finish subject to timings and build stage.

Some of the many development highlights and specification will though include;

*** Allocated secure underground parking spaces with 7.4kW EV charging point * Private Terrace or balcony * 10 year structural warranty * Lift serving all floors and basement parking * Contemporary designed kitchens with clean lines and a blend of textures and finishes * Modern bathrooms with large format tiling to all walls and floors * CAT6, BT and SKY+HD/Q wiring to living areas, and all bedrooms * Zoned underfloor gas central heating with individual room controls and Central LCD heating controls with facility for remote smartphone operation * NSI intruder alarm system with motion detectors, door contacts and facility for remote smartphone operation**

Apartments are offered for sale with a share within the freehold to building. Pets are accepted.

PRICES RANGE FROM £595,000 - £1.55M – Please ask for our full price list, individual floorplans, and apartment availability.

We welcome your early enquiry and look forward to securing you your new cliff top home.



KEY POINTS

- Stunning new development
- Sea and coastal views
- Secure underground parking
- Lift serving all floors
- South facing patios/balconies
- Reservation now available!

Site Plan

echo beach

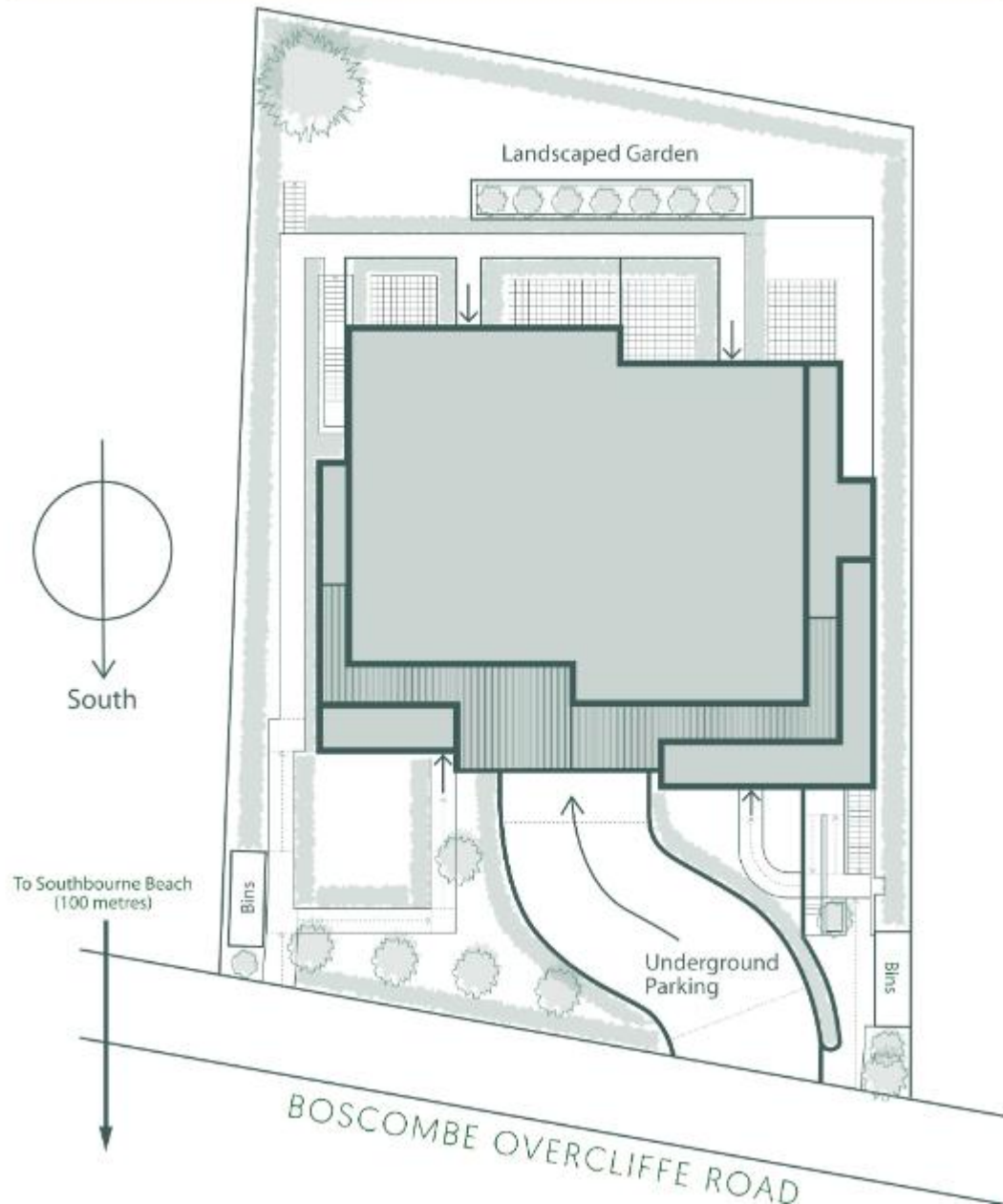

The Consumer Protection from Unfair Trading Regulations 2008 (CPRs). These details are for guidance only and complete accuracy cannot be guaranteed. If there is any point, which is of particular importance, verification should be obtained. They do not constitute a contract or part of a contract. All measurements are approximate. No guarantee can be given with regard to planning permissions or fitness for purpose. No apparatus, equipment, fixture or fitting has been tested. Items shown in photographs are NOT necessarily included. Interested Parties are advised to check availability and make an appointment to view before travelling to see a property.

THE PROPERTY PROFESSIONALS Christchurch | Southbourne | Highcliffe | Bransgore



Slades - Southbourne 51 Southbourne Grove, Bournemouth, Dorset, BH6 3QT
01202 428555 | sales@sladessouthbourne.co.uk
Website www.sladeshomes.co.uk

Slades