

47 Chestnut Way, Burton, Christchurch,  
Dorset, BH23 7LR

Guide Price **£300,000**



Bedrooms



Living



Bathroom



Garage



EST  
1992

THE PROPERTY PROFESSIONALS  
Slades Estate Agents

*Slades*



# A Three Bedroom House in Burton

---

THIS THREE BEDROOM TERRACED HOUSE IS SITUATED IN THE POPULAR VILLAGE OF BURTON. THE PROPERTY IS WELL PRESENTED AND FEATURES AN INTEGRAL GARAGE.

47 Chestnut Way is an opportunity to purchase a three bedroom house in the sought after village of Burton. The property is just a short level walk from the Village Green, local shops and parish church. Christchurch Town Centre is approx 2 miles away with its historic 11th Century Priory, Town Quay and excellent range of coffee shops, bars and restaurants.

The front door leads into the entrance hall. The generous lounge/diner has a window to the front and a useful understairs storage area. The kitchen is set to the rear of the property with a range of base and eye level units and some integral appliances.

Stairs from the lounge/diner lead to the first floor landing. There are three bedrooms. The bathroom features a wc, basin and bath.

The property has front and rear gardens which are both designed with ease of maintenance in mind. There is a bike shed to the front of the property. Double gates to the rear of the property can provide vehicular access for OFF ROAD PARKING if required. The INTEGRAL GARAGE can be accessed from the rear garden.

TENURE: FREEHOLD  
COUNCIL TAX BAND: C



## KEY POINTS

- THREE BEDROOMS
- TERRACED HOUSE
- INTEGRAL GARAGE
- POPULAR VILLAGE
- WELL PRESENTED
- REAR GATES FOR PARKING

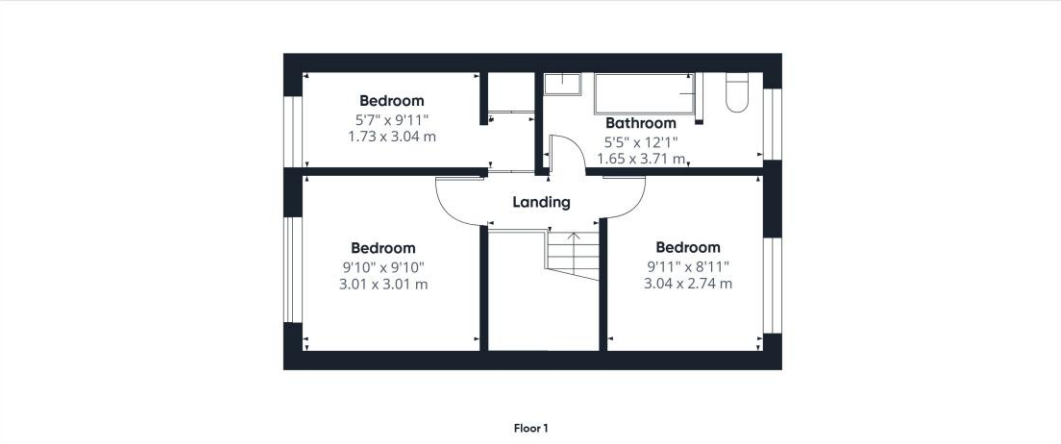

**Approximate total area<sup>(1)</sup>**  
844 ft<sup>2</sup>  
78.4 m<sup>2</sup>

(1) Excluding balconies and terraces

Calculations reference the RICS IPMS 3C standard. Measurements are approximate and not to scale. This floor plan is intended for illustration only.

GIRAFFE360



# THE PROPERTY PROFESSIONALS

Christchurch | Southbourne | Highcliffe | Bransgore

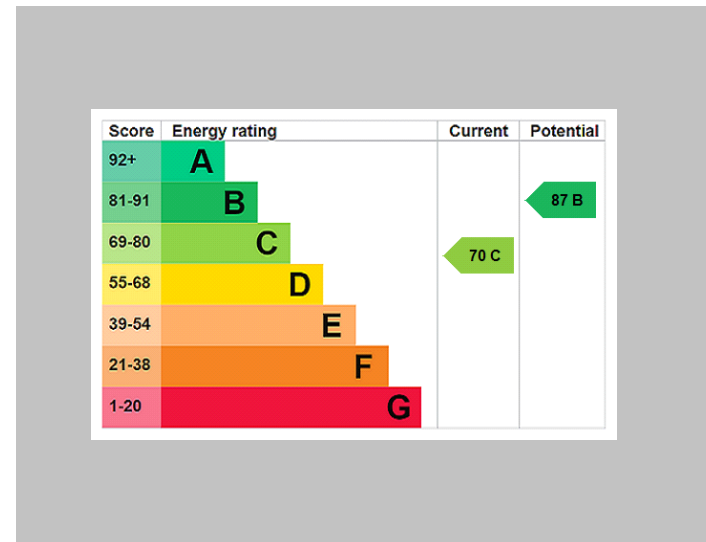

**Slades - Christchurch** 7 Castle Street, Christchurch, Dorset, BH23 1DP  
01202 474202 | [enquiries@sladeschristchurch.co.uk](mailto:enquiries@sladeschristchurch.co.uk)  
**Website** [www.sladeshomes.co.uk](http://www.sladeshomes.co.uk)

