

48 Rothesay Drive, Highcliffe, Dorset, BH23 4LD

Guide Price: £975,000



A well-presented, charming two-bedroom bungalow...

A well-presented charming two-bedroom bungalow set in one of the area's best roads – Rothesay Drive. The property features a large and private garden with the rear siding onto Highcliffe Golf Course.

This bungalow offers plenty of potential, you could extend and improve, subject to the appropriate planning consents, of which the precedence has been set on road for significant development.

Entry via front door to entrance hall with access into the dining area. To the left of the property is the sitting room, with bay window to front and log burner. The cosy sitting room opens into the living room with bifolds to the rear garden. The kitchen/breakfast is situated on the right-hand side of the property, with the kitchen featuring a range of eye and base level units. The principal bedroom features an ensuite shower room. A family bathroom and second bedroom complete the accommodation.

Externally the rear garden is a real asset, spanning approximately 0.42 acres. There is an area of patio and the rest is predominately laid to lawn, with shrub/tree borders. To the rear is a garden chalet and the garden sides onto Highcliffe Golf Course.

The front features a drive with plenty of space for vehicles and side access.

Tenure: Freehold
EPC Rating: D
Council Tax Band: F



KEY POINTS

- Rothesay Drive
- Large rear garden
- Private and idyllic setting
- One of the area's most sought-after roads
- Potential to improve/extend



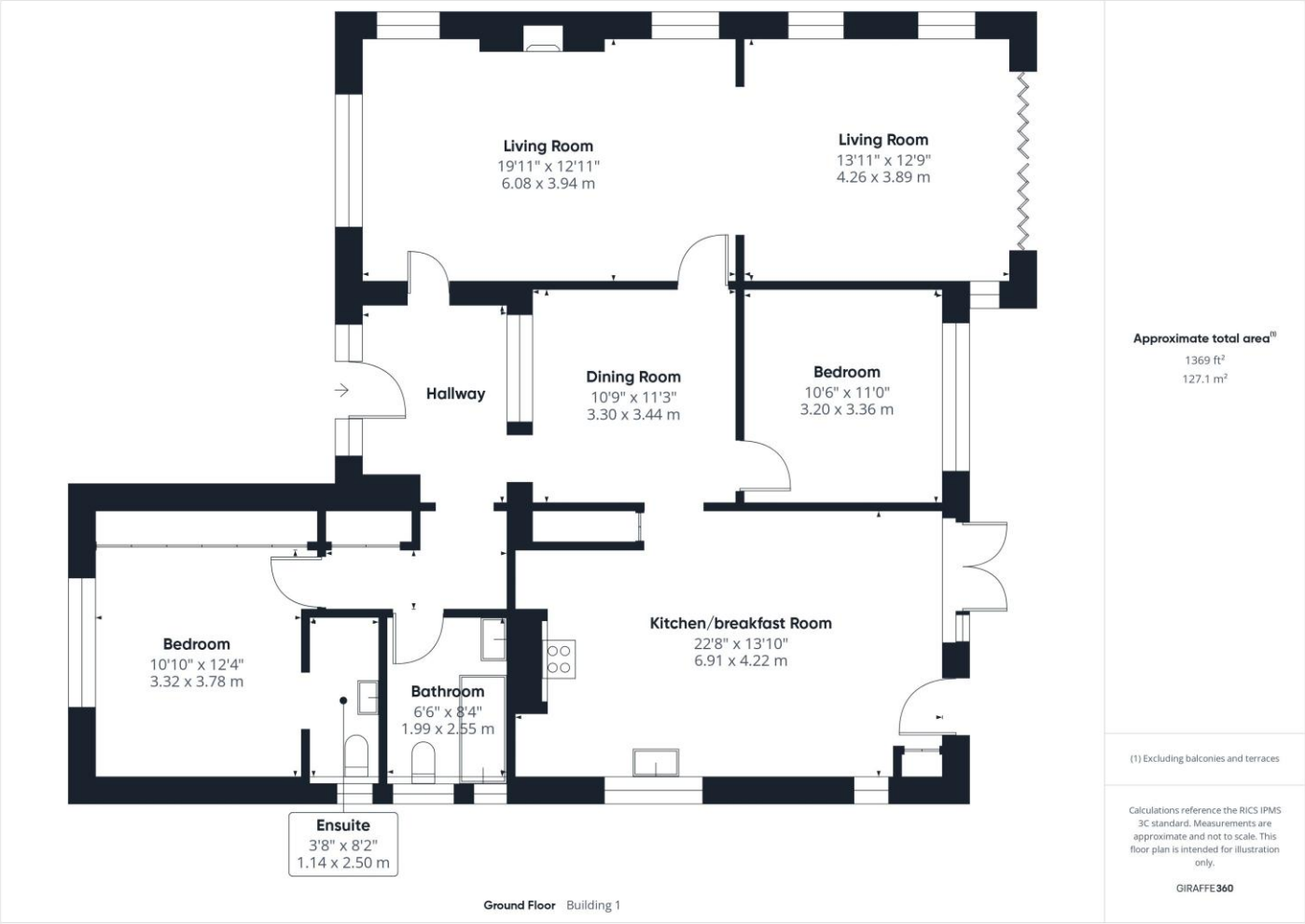

The Consumer Protection from Unfair Trading Regulations 2008 (CPRs). These details are for guidance only and complete accuracy cannot be guaranteed. If there is any point, which is of particular importance, verification should be obtained. They do not constitute a contract or part of a contract. All measurements are approximate. No guarantee can be given with regard to planning permissions or fitness for purpose. No apparatus, equipment, fixture or fitting has been tested. Items shown in photographs are NOT necessarily included. Interested Parties are advised to check availability and make an appointment to view before travelling to see a property.

THE PROPERTY PROFESSIONALS Christchurch | Southbourne | Highcliffe | Bransgore



Fine & Country 7 Castle Street, Christchurch, Dorset, BH23 1DP
01202 488988 | Christchurch@fineandcountry.com
Website www.fineandcountry.co.uk