

Flat 4, Gilbert Court, 104 Bargates,
Christchurch, Dorset, BH23 1QP

Asking Price **£175,000**



1

Bedrooms



1

Living



1

Bathroom/Ensuite



*

Parking/Garage



EST
1992

THE PROPERTY PROFESSIONALS
Slades Estate Agents

Slades

A GENEROUS ONE BEDROOM FIRST FLOOR FLAT

THIS GENEROUS ONE BEDROOM FIRST FLOOR FLAT IS JUST A SHORT DISTANCE TO CHRISTCHURCH TOWN CENTRE & TRAIN STATION. THERE IS ALSO AN ALLOCATED PARKING SPACE.

Flat 4 Gilbert Court is an opportunity to purchase a spacious first floor flat in a popular and convenient location. The property is situated within half a mile of Christchurch Town Centre with its historic 11th Century Priory, Town Quay and various shops, cafes, bars and restaurants. There are regular bus services nearby as well as Christchurch main line railway station.

There is a communal entrance and stairs lead to the first floor where Flat 4 can be found. The front door leads into the entrance hall. The lounge is of a good size and a door leads through to the kitchen which has a range of base and eye level units and space for a cooker, washing machine & fridge freezer. The double bedroom is set to the front of the property and has plenty of additional space for wardrobes & units. The recently modernised shower room comprises wc, wash hand basin and walk in shower.

To the rear of the property there is an ALLOCATED PARKING SPACE.

TENURE: LEASEHOLD. We understand that there are 103 years left on the lease with a ground rent of £200pa and a maintenance charge of approx £1100pa.

COUNCIL TAX BAND: B

AGENTS NOTE: In accordance with the Estate Agents Act 1979 (amended) Slades Estate Agents, Christchurch have to declare a personal interest in this property under the terms of the Act.



KEY POINTS

- DOUBLE BEDROOM
- CENTRAL CHRISTCHURCH
- ALLOCATED PARKING
- CLOSE TO STATION
- WELL PRESENTED

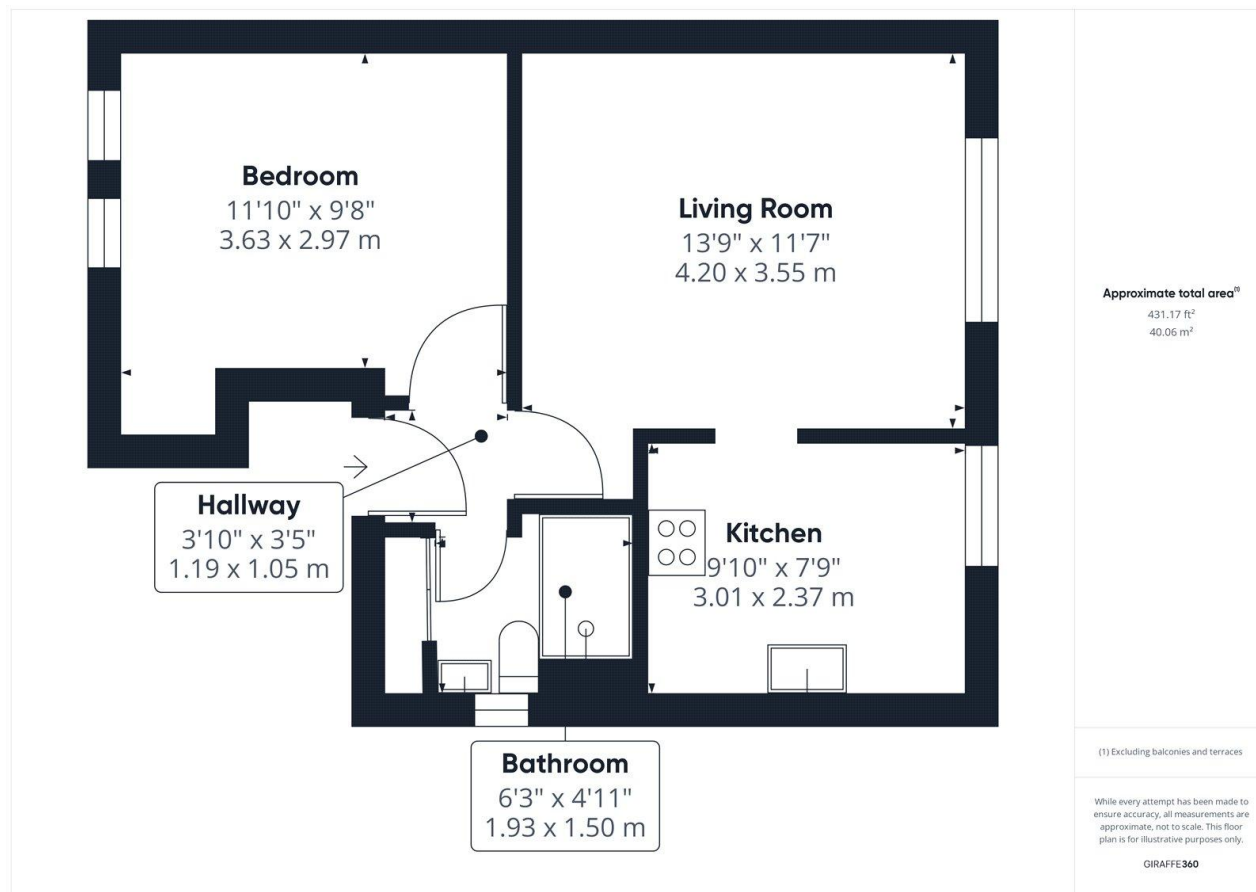

THE PROPERTY PROFESSIONALS Christchurch | Southbourne | Highcliffe | Bransgore

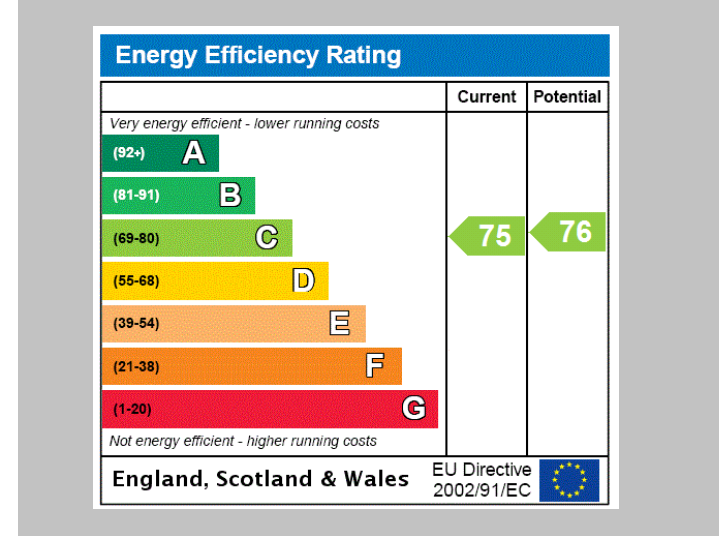

Slades - Christchurch 7 Castle Street, Christchurch, Dorset, BH23 1DP
01202 474202 | enquiries@sladeschristchurch.co.uk
Website www.sladeshomes.co.uk

